

Instrument of Renewal

Section 114 of the *Mining Act 1992*

I, **Georgina Beattie, Chief Executive Officer, Mining, Exploration and Geoscience**, as delegate for the Minister administering the *Mining Act 1992* for the State of New South Wales, pursuant to section 114 of the *Mining Act 1992*, have determined to renew **Mining Lease 1529 (Act 1992)**, as described in Schedule 1, to **White Mining (NSW) Pty Limited, ACN 089 414 595**, subject to the conditions:

1. prescribed in the *Mining Act 1992* and the Mining Regulation 2016; and
2. set out in Schedule 2.

Note: For the avoidance of doubt, any prior Description of Lease and any Conditions imposed prior to the effective date of this Instrument of Renewal are replaced by Schedule 1 and 2 of this Instrument of Renewal on and from the effective date.

Signed this 12th day of July 2022



Georgina Beattie
Chief Executive Officer
Mining, Exploration and Geoscience
Regional NSW
As delegate for the Minister administering the *Mining Act 1992*
Delegation dated: 14 May 2018

SCHEDULE 1

Description of Lease

Mining lease:	1529 (Act 1992)
Renewal date:	12 July 2022
Effective date:	12 July 2022
Term ending (expiry date):	11 November 2030
Lease Holder(s)	White Mining (NSW) Pty Limited, ACN 089 414 595
Land:	The lease area includes all land described in the attached lease plan titled M27012R and approved on 18 August 2003 .
Area:	128.7 hectares
Surface Exception:	Whole 20 metres
Depth Restriction:	Whole 900 metres below Australian Height Datum
Mineral(s):	Coal

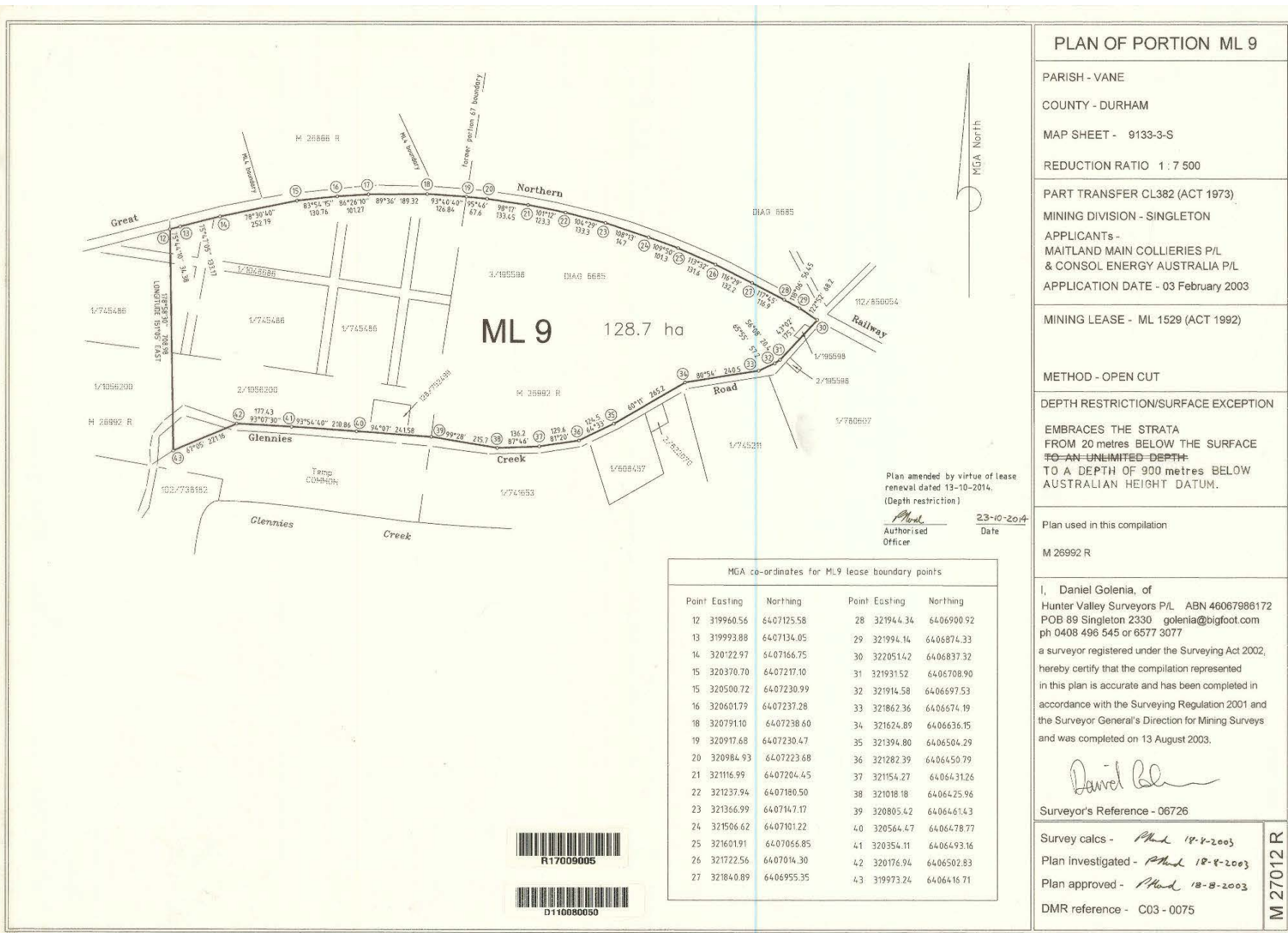

PLAN OF PORTION ML 9

PARISH - VANE
 COUNTY - DURHAM
 MAP SHEET - 9133-3-S
 REDUCTION RATIO 1 : 7 500

PART TRANSFER CL382 (ACT 1973)
 MINING DIVISION - SINGLETON
 APPLICANTS -
 MAITLAND MAIN COLLIERIES P/L
 & CONSOL ENERGY AUSTRALIA P/L
 APPLICATION DATE - 03 February 2003

MINING LEASE - ML 1529 (ACT 1992)

METHOD - OPEN CUT

DEPTH RESTRICTION/SURFACE EXCEPTION
 EMBRACES THE STRATA
 FROM 20 metres BELOW THE SURFACE
 TO AN UNLIMITED DEPTH
 TO A DEPTH OF 900 metres BELOW
 AUSTRALIAN HEIGHT DATUM.

Plan used in this compilation
 M 26992 R

I, Daniel Golenia, of
 Hunter Valley Surveyors P/L ABN 46067986172
 POB 89 Singleton 2330 golenia@bigfoot.com.au
 ph 0408 496 545 or 6577 3077
 a surveyor registered under the Surveying Act 2002,
 hereby certify that the compilation represented
 in this plan is accurate and has been completed in
 accordance with the Surveying Regulation 2001 and
 the Surveyor General's Direction for Mining Surveys
 and was completed on 13 August 2003.

David Golenia
 Surveyor's Reference - 06726

Survey calcs - *Phd 18-8-2003*
 Plan investigated - *Phd 18-8-2003*
 Plan approved - *Phd 18-8-2003*
 DMR reference - C03-0075

M 27012 R

MGA co-ordinates for ML9 lease boundary points

Point	Easting	Northing	Point	Easting	Northing
12	319960.56	6407125.58	28	321944.34	6406900.92
13	319993.88	6407134.05	29	321994.14	6406874.33
14	320122.97	6407166.75	30	322051.42	6406837.32
15	320370.70	6407217.10	31	321931.52	6406708.90
16	320500.72	6407230.99	32	321914.58	6406697.53
17	320601.79	6407237.28	33	321862.36	6406674.19
18	320791.10	6407238.60	34	321624.89	6406636.15
19	320917.68	6407230.47	35	321394.80	6406504.29
20	320984.93	6407223.68	36	321282.39	6406450.79
21	321116.99	6407204.45	37	321154.27	6406431.26
22	321237.94	6407180.50	38	321018.18	6406425.96
23	321366.99	6407147.17	39	320805.42	6406414.43
24	321506.62	6407101.22	40	320564.47	6406478.77
25	321601.91	6407066.85	41	320354.11	6406493.16
26	321722.56	6407014.30	42	320176.94	6406502.83
27	321840.89	6406955.35	43	319973.24	6406416.71

SCHEDULE 2

Mining Lease Conditions 2021

(Version 1.1 as at February 2022)

Definitions

Words used in this mining lease have the same meaning as defined in the *Mining Act 1992* except where otherwise defined below:

Term	Definition
Act	means the <i>Mining Act 1992</i> .
Landholder	for the purposes of these conditions: <ul style="list-style-type: none">• does not include a secondary landholder• includes, in the case of exempted areas, the controlling body for the exempted area.
Minister	means the Minister administering the Act.

Note:

1. The rights and duties of the Lease Holder(s) are those prescribed by the *Mining Act 1992* and the Mining Regulation 2016, subject to the terms and conditions of this mining lease.
2. This mining lease does not override any obligation on the lease holder(s) to comply with the requirements of other legislation and regulatory instruments which may apply (including all relevant development approvals) unless specifically provided under the *Mining Act 1992* or other legislation or regulatory instruments.

Mining Lease Conditions 2021	Version Date: February 2022 (Version 1.1)
Mining Lease 1529 (Act 1992)	Page 4 of 7

MINING LEASE CONDITIONS

Standard conditions

See Mining Regulation 2016, Schedule 8A, Part 2.

NOTE TO HOLDERS: The prescribed standard conditions in the Mining Regulation 2016, Schedule 8A, Part 2 apply in addition to the conditions in this Schedule 2 (but have not been replicated in this mining lease). The conditions imposed by the Mining Regulation 2016 prevail to the extent of any inconsistency with the conditions in this Schedule 2.

General conditions

1. Notice to Landholders

- (a) Within 90 days from the date of grant or renewal of this mining lease, the lease holder must give each landholder notice in writing:
- (i) that this mining lease has been granted or renewed; and
 - (ii) whether the lease includes the surface.

The notice must include a plan identifying the lease area and each landholder and individual land parcel within the lease area.

- (b) If there are ten or more landholders to which notice must be given, the lease holder will be taken to have complied with condition 1(a) if a notice complying with condition 1(a) is published in a newspaper circulating in the region where the lease area is situated.

2. Group Security

The lease holder is required to provide and maintain a security deposit to secure funding for the fulfilment of obligations under the mining leases covered by the group security deposit, including obligations under each mining lease that may arise in the future.

The amount to be provided and maintained as a group security deposit is **\$23,852,000**.

The leases covered by the group security include:

Mining Lease 1529 (Act 1992) (Head lease)
Mining Lease 1533 (Act 1992)
Mining Lease 1623 (Act 1992)
Mining Lease 1696 (Act 1992)

3. Cooperation Agreement

The lease holder must make every reasonable attempt and be able to demonstrate its attempts to the satisfaction of the Secretary, to enter into a cooperation agreement with the holder(s) of any overlapping authorisations issued under the *Mining Act 1992* and

Mining Lease Conditions 2021	Version Date: February 2022 (Version 1.1)
Mining Lease 1529 (Act 1992)	Page 5 of 7

petroleum titles issued under the *Petroleum (Onshore) Act 1992*. The cooperation agreement should address but not be limited to:

- access arrangements
- operational interaction procedures
- dispute resolution
- information exchange
- well location
- timing of drilling
- potential resource extraction conflicts; and
- rehabilitation issues.

4. Assessable Prospecting Operations

- (a) The lease holder must not carry out any assessable prospecting operation on land over which this lease has been granted unless:
 - (i) it is carried out in accordance with any necessary development consent; or
 - (ii) if development consent is not required, the prior written approval of the Minister has been obtained.
- (b) The Minister may require the lease holder to provide such information as required to assist the Minister to consider an application for approval.
- (c) An approval granted by the Minister under this condition may be granted subject to terms.
- (d) The lease holder must comply with the approval granted to the holder under this condition.

Mining Lease Conditions 2021	Version Date: February 2022 (Version 1.1)
Mining Lease 1529 (Act 1992)	Page 6 of 7

Special conditions

Nil

Exploration Reporting

Note: Exploration Reports (Geological and Geophysical)

The lease holder must lodge reports in accordance with the requirements in section 163C of the *Mining Act 1992* and clauses 59, 60 and 61 of the Mining Regulation 2016 as well as any further requirements issued by the Secretary under clause 62 of the Mining Regulation 2016.

Guidelines for the structure, content and data format requirements for reports are set out in the *Exploration Reporting: A guide for reporting on exploration and prospecting in New South Wales*.

Mining Lease Conditions 2021	Version Date: February 2022 (Version 1.1)
Mining Lease 1529 (Act 1992)	Page 7 of 7